

LAS-D Sample Drying Cabinet



The LAS-D uses HEPA or ULPA filtration to create a clean benchtop, storage solution for sample drying applications. The polypropylene construction creates a rust free cabinet option for use with acids and corrosives as well as any metal free lab protocol. Acrylic or polycarbonate bi-fold doors and perimeter LED lighting creates clear and unobstructed monitoring and convenient sample access.

INDUSTRIES SERVED

- Geology
- Metallurgy
- Histology
- General Lab Drying
- Education

FEATURES

STANDARD FEATURES

- A. Rust Free Polypropylene Construction
- B. HEPA Filtration
- C. Bi-Fold Front Access Doors
- D. Five Adjustable Shelves
- E. Perimeter LED Lighting

OPTIONAL FEATURES

- F. Convection Heat (50 Deg. Above Ambient)
 - G. Base Cabinet, Table and Cart Supports
 - H. Airflow Speed Controller
- ULPA Filtration
 - Single Door Configuration

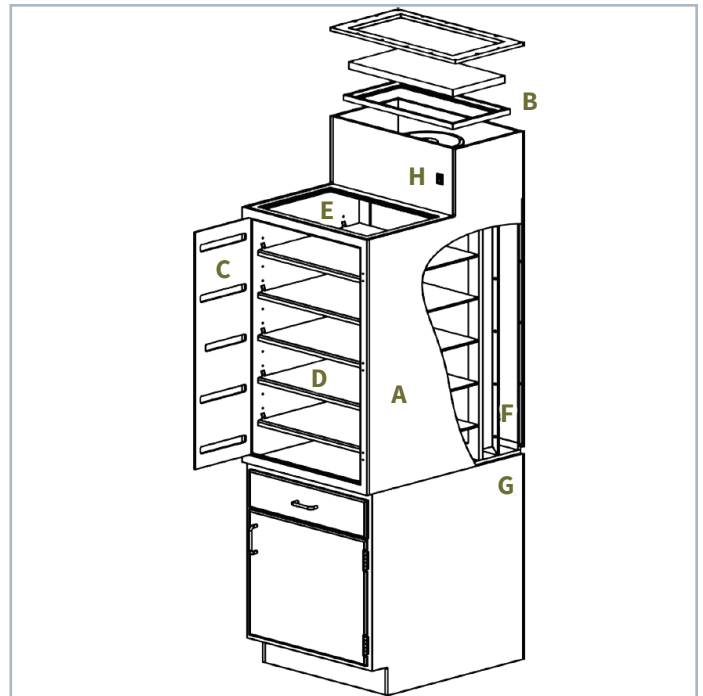

LAS-D Data Sheet

OVERALL DIMENSIONS

	2 FOOT	3 FOOT	4 FOOT
Width	24"	36"	58"
Depth	30"	30"	30"
Height	46"	46"	46"

WORK AREA DIMENSIONS

Width	21.5"	33.5"	45.5"
Depth	22"	22"	22"
Height	33.5"	33.5"	33.5"

AIRFLOW CHARACTERISTICS

Airflow Velocity	50 fpm	50 fpm	50 fpm
Light Intensity Foot Candles	105	105	105
CFM	200	250	300

WARRANTY

1 Year Parts Only



9650 Newton Ave. S
Bloomington, MN 55431



877.410.4910



info@labairesystems.com



www.labairesystems.com